

TOTAL EXTENT (LEAST EXTENT AS PER PATTI) :

2500 SQ.M ✓

ROAD AREA :

622 SQ.M ✓

NO.OF.PLOTS :

8 Nos. ✓

NOTE:

1. SPLAY - 3.0M X 3.0M
2. MEASUREMENTS ARE INDICATED EXCLUDING SPLAY DIMENSION.
3. ROAD AREA WAS HANDED OVER TO THE LOCAL BODY
VIDE GIFT DEED DOCUMENT NO.5228/2020 DATED;20.05.2020 @ SROKUNDRATHUR

CONDITION :

TNCDBR-2019,RULE NO : 47 (11) ✓

THE COST OF LAYING IMPROVEMENTS TO THE SYSTEMS IN RESPECT OF ROAD, WATER SUPPLY, SEWERAGE, DRAINAGE OR ELECTRIC POWER SUPPLY THAT MAY BE REQUIRED AS ASSESSED BY THE CONCERNED AUTHORITY,NAMELY,THE LOCAL BODY AND TAMIL NADU ELECTRICITY BOARD, SHALL BE BORNE BY THE APPLICANT.

- ⊙ NECESSARY SPACE FOR BUILDING LINE TO BE LEFT AS PER THE RULE IN FORCE WHILE TAKING UP DEVELOPMENT IN EVERY PLOT.

LEGEND :

- SITE BOUNDARY ✓
- ▨ ROADS GIFTED TO LOCAL BODY ✓
- ▨ EXISTING ROAD ✓

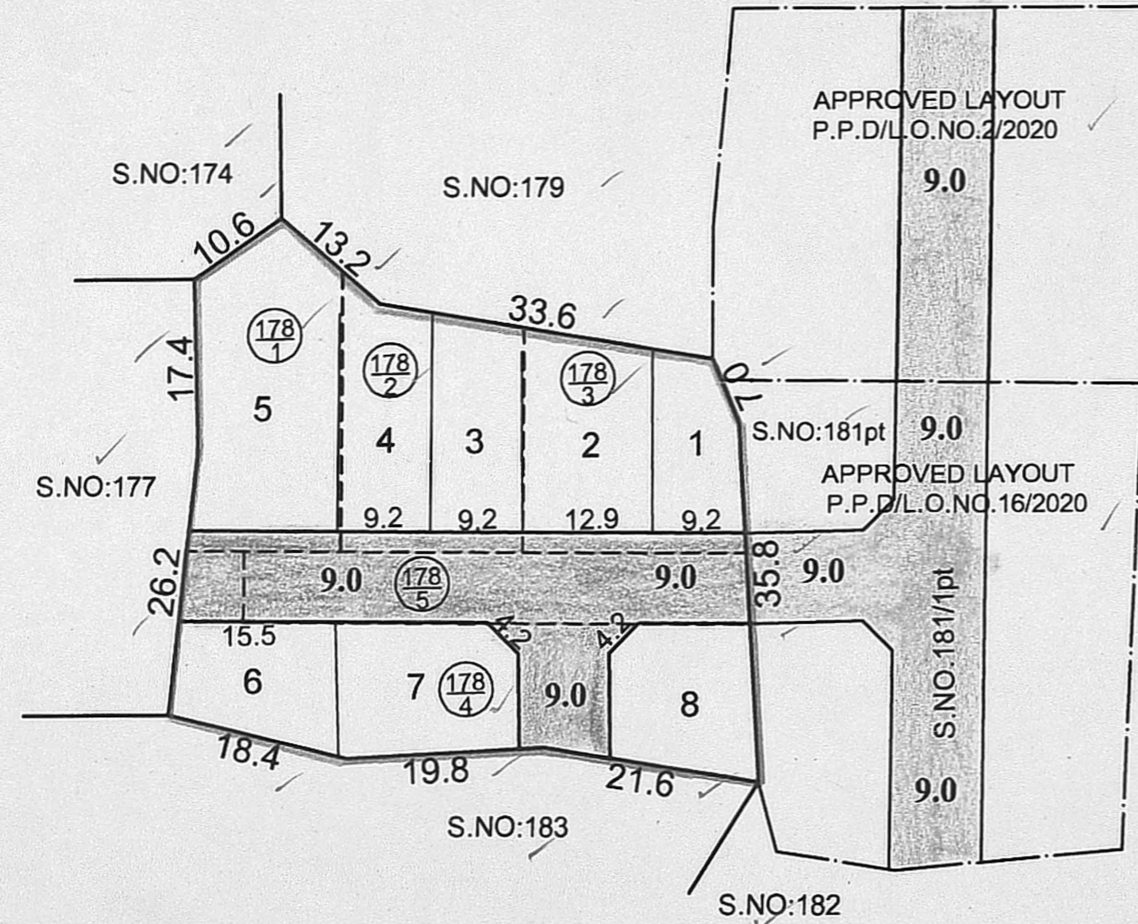

S. Shrinani
8/6/2020
PREPARED BY

10/06/2020
P.A.II

17/06/2020
A.P

KUNDRATHUR PANCHAYAT UNION

SUB-DIVISION OF HOUSE SITES IN S.Nos.178/1, 2,3,4 & 178/5 OF MALAYAMBAKKAM VILLAGE.

SCALE-1:800 (ALL MEASUREMENTS ARE IN METRE)

CONDITION:-

THE SUB-DIVISION APPROVAL IS VALID SUBJECT TO OBTAINING SANCTION FROM THE LOCAL BODY CONCERNED

P.P.D NO 43
L.O 2020

APPROVED

VIDE LETTER NO : L1 / 2750 / 2020

DATED : 10 / 06 / 2020

10/6/20
A/S
FOR CHIEF PLANNER(LAYOUT)
CHENNAI METROPOLITAN
DEVELOPMENT AUTHORITY

